

**NEW YORK STATE THRUWAY AUTHORITY
DEPARTMENT OF ENGINEERING**

**ALBANY, NY
JANUARY 5, 2024**

**AMENDMENT NO. 1
TO**

**CONTRACT TAS 24-5B
D214950
REHABILITATION OF THE I-90 EB & I-90 WB
BRIDGES OVER STERLING CREEK AT
MILEPOSTS 227.40 AND 227.41
IN THE SYRACUSE DIVISION
OF THE NEW YORK STATE THRUWAY
IN HERKIMER COUNTY**

**IN THE LETTING OF
JANUARY 10, 2024**

NOTE: This amendment shall be attached to and become a part of the Proposal for Contract **TAS 24-5B**.

NOTICE

Questions and Answers for this project are available from the Authority’s website, specifically at: http://www.thruway.ny.gov/netdata/contractors/documents/d214950_tas24-5b_questions-and-answers-01-05-2024.pdf. This document may be updated periodically without formal issuance of an Amendment. Prospective bidders are advised to revisit this link weekly and before proposals are due, for any possible additional questions and answers information.

Additional Supplemental Information for this project is now available from the Authority’s website, specifically at: http://www.thruway.ny.gov/netdata/contractors/documents/d214950_tas24-5b_supplemental-information-01-05-2024.zip

The revised quantity workups to reflect the changes as mentioned below are now available and are being provided as additional supplemental information.

PROPOSAL

1. **CHANGE** the estimated quantity for the following Item:

<u>Contract Proposal Page</u>	<u>Item No.</u>	<u>Description</u>	<u>Unit</u>	<u>Initial Estimated Quantity</u>	<u>Revised Estimated Quantity</u>
163	203.02	Unclassified Excavation and Disposal	CY	3,620	5,450
163	203.03	Embankment in Place	CY	415	1,360
164	404.000011	Plant Production Quality Adjustment to Asphalt Items	QU	80	87

<u>Contract Proposal Page</u>	<u>Item No.</u>	<u>Description</u>	<u>Unit</u>	<u>Initial Estimated Quantity</u>	<u>Revised Estimated Quantity</u>
167	603.051116	Corrugated Steel Pipe (2-2/3 Inch X 1/2 Inch) - 15 Inch, 16 Gauge	LF	104	164
167	603.171116	Galvanized Steel End Section - Pipe (2-2/3 Inch X 1/2 Inch Corrugations) - 15 Inch Diameter, 18 Gauge	EA	4	6
172	627.5014 08	Cutting Pavement	LF	250	2,800

The Bidder shall **CROSS OUT** the estimated quantity shown for these items in the Contract Proposal, **WRITE IN** the revised estimated quantity, and submit its bid based on the noted changes. If the Bidder fails to make these changes, the Authority will do so and adjust the BID AMOUNT for the items and TOTAL BID accordingly.

2. **ADD** the following Item:

<u>Contract Proposal Page</u>	<u>Item No.</u>	<u>Description</u>	<u>Unit</u>	<u>Estimated Quantity</u>
173A-A1	404.017901	True and Leveling F9, Asphalt, 70 Series Compaction	TON	140

The Bidder must **RETURN THE ATTACHED PAGE 173A-A1** with its bid for this Contract.

PLANS

3. **DELETE** Drawing Number TYP-2, Sheet 38 of 87, and **REPLACE** with Drawing Number TYP-2, Sheet 38-A1 of 87.
 - Reference to Item 404.017901 was added and other items not previously shown in the details were removed from the Items Table.
 - A Median Restoration Detail for the proposed temporary paved median has been provided in the bottom middle of the plan sheet.
4. **DELETE** Drawing Number GP-1, Sheet 43 of 87, and **REPLACE** with Drawing Number GP-1, Sheet 43-A1 of 87.
 - New Notes 4 and 5 have been added. The limits and intent of proposed work has been clarified and applicable pay items have been identified. Reference is made to the Median Restoration Detail as provided in amended Drawing Number TYP-2, Sheet 38-A1 of 87, attached herein.
5. **DELETE** Drawing Number GP-2, Sheet 44 of 87, and **REPLACE** with Drawing Number GP-2, Sheet 44-A1 of 87.
 - New Note 5 has been added. Reference is made to the Median Restoration Detail as provided in amended Drawing Number TYP-2, Sheet 38-A1 of 87, attached herein.

6. **DELETE** Drawing Number GP-3, Sheet 45 of 87, and **REPLACE** with Drawing Number GP-3, Sheet 45-A1 of 87.
 - New Note 4 has been added. Reference is made to the Median Restoration Detail as provided in amended Drawing Number TYP-2, Sheet 38-A1 of 87, attached herein.

7. **DELETE** Drawing Number ST-41, Sheet 86 of 86, and **REPLACE** with Drawing Number ST-41, Sheet 86-A1 of 87.
 - All rebar used on this contract shall be galvanized. Any previous mention of epoxy was removed and changed to galvanized.
 - Eastbound End Abutment for Placement 3 was reorganized (grouped together), but the subtotals for galvanized bars remain the same.

8. **DELETE** Drawing Number ST-42, Sheet 87 of 87, and **REPLACE** with Drawing Number ST-42, Sheet 87-A1 of 87.
 - All rebar used on this contract shall be galvanized. Any previous mention of epoxy was removed and change to galvanized.
 - Westbound End Abutment for Placement 3 was reorganized (grouped together), but the subtotals for galvanized bars remain the same.

The Bidder **MUST** complete Page **188** of the Proposal acknowledging receipt of this amendment. If the Bidder fails to complete the “Amendment Acknowledgement” sheet, his bid could be declared informal thereby delaying award of the contract.

PLEASE BE GOVERNED ACCORDINGLY WHEN SUBMITTING BIDS.

Richard W. Lee, P.E.
Chief Engineer



01/04/2024 3:47:16 PM

AASHTOWare Project™ Version 5.00 Revision 031

Proposal Schedule of Items

Proposal ID: D214950

Project(s): S53075

Contractor: _____

SECTION: 0001 SECTION 1

Alt Set ID: **Alt Mbr ID:**

Proposal Line Number	Item ID Description	Approximate Quantity and Units	Unit Price		Bid Amount	
			Dollars	Cents	Dollars	Cents
0300	404.017901 TRUING AND LEVELING F9, ASPHALT, 70 SERIES COMPACTION	140.000 TON	_____	_____	_____	_____

CHECKED BY: N. BARNHARD
 DRAFTED BY: T. LINDO
 CHECKED BY: N. BARNHARD
 DESIGNED BY: C. SICHAK

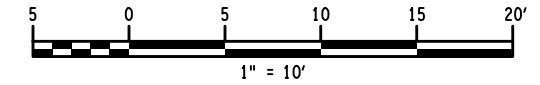
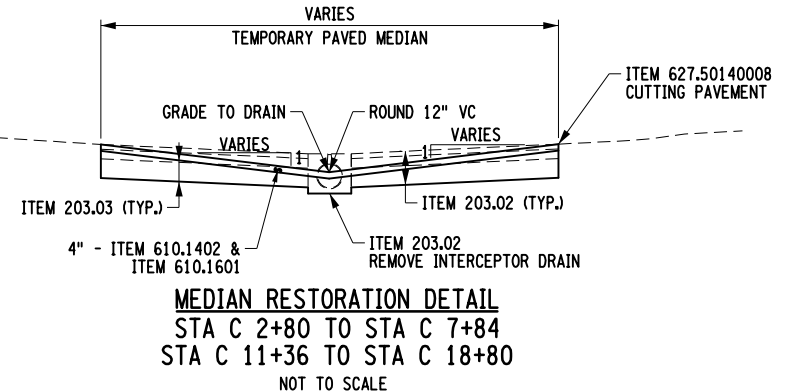
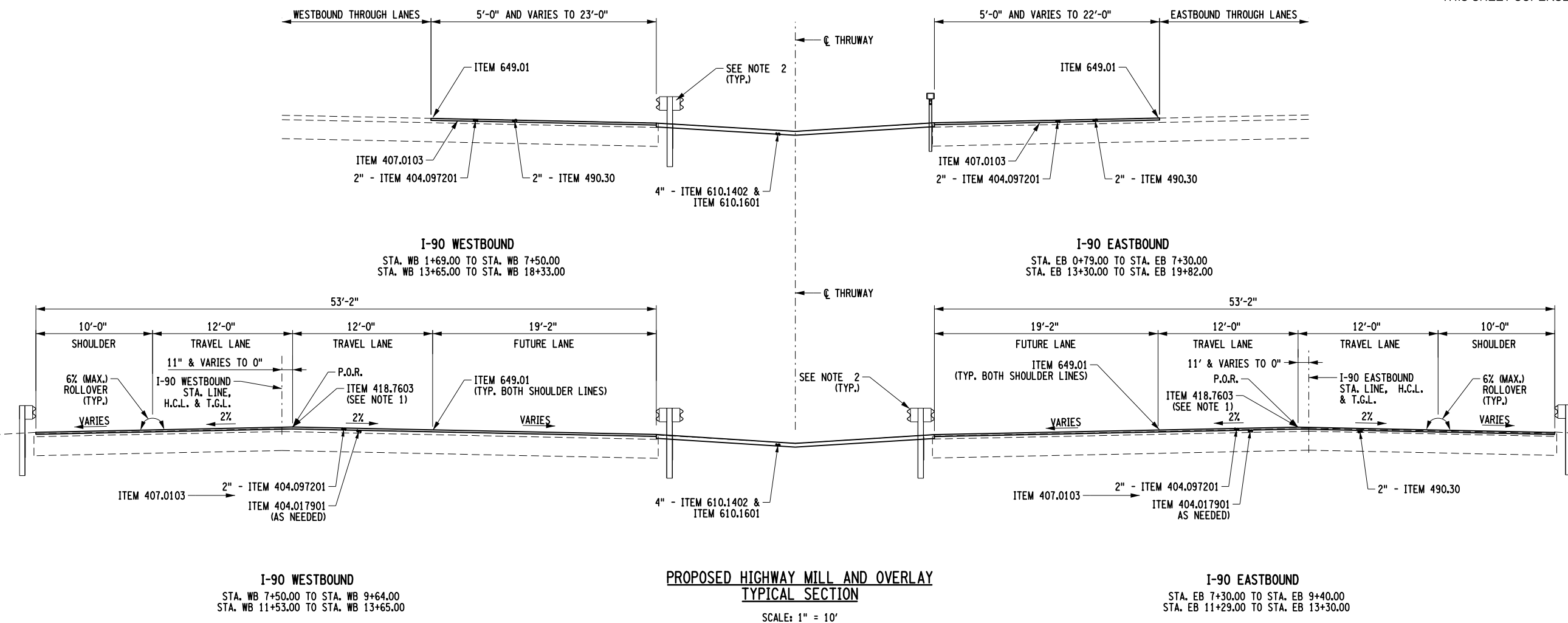

FILE NAME = B2221_cph_sec_typ2_A1.dgn
 DATE/TIME = 04-JAN-2024 14:07
 USER = Stchak

ALTERED ON: _____

AFFIKED ON: 01/04/2024

SIGNATURE: _____
STAMP: _____

ITEM	DESCRIPTION	UNIT	ITEM	DESCRIPTION	UNIT
203.02	UNCLASSIFIED EXCAVATION AND DISPOSAL	CY	610.1601	TURF ESTABLISHMENT - ROADSIDE	SY
203.03	EMBANKMENT IN PLACE	CY	649.01	MILLED-IN AUDIBLE ROADWAY DELINEATORS (MIARDS)	LF
304.12	SUBBASE COURSE, TYPE 2	CY	627.50140008	CUTTING PAVEMENT	LF
404.017901	TRUE & LEVELING F9, ASPHALT, 70 SERIES COMPACTION	TON			
404.097201	9.5 F2 TOP COURSE ASPHALT, 70 SERIES COMPACTION	TON			
407.0103	STRAIGHT TACK COAT	GAL			
418.7603	ASPHALT PAVEMENT JOINT ADHESIVE	LF			
490.30	MISCELLANEOUS COLD MILLING OF BITUMINOUS CONCRETE	SY			
610.1402	TOPSOIL - ROADSIDE	CY			

REVISIONS			
DATE	DESCRIPTION	BY	SYM.

NOTES:

- ASPHALT JOINT ADHESIVE, ITEM 418.7603, SHALL BE USED ON VERTICAL FACES FOR ALL THE JOINTS ON THE SURFACE COURSE SUCH AS LONGITUDINAL, TRANSVERSE, OR OTHER JOINTS ABUTTING THE NEW ASPHALT PAVEMENT.
- SEE GUIDE RAIL TABLE ON DWG. MT-1 FOR LOCATION OF WORK.

TITLE OF PROJECT: STERLING CREEK BRIDGE REHABILITATION
 LOCATION OF PROJECT: SYRACUSE DIVISION
 BIN 5516091 & 5516092 MP 227.40 & MP 227.41
 TITLE OF DRAWING: PROPOSED SECTIONS

CONTRACT NUMBER: TAS 24-5B
 DATE: NOV. 2023
 DRAWING NUMBER: TYP-2

IT IS A VIOLATION OF LAW FOR ANY PERSON, UNLESS THEY ARE ACTING UNDER THE DIRECTION OF A LICENSED PROFESSIONAL ENGINEER, ARCHITECT, LANDSCAPE ARCHITECT, OR LAND SURVEYOR, TO ALTER AN ITEM IN ANY WAY. IF AN ITEM BEARING THE STAMP OF A LICENSED PROFESSIONAL IS ALTERED, THE ALTERING ENGINEER, ARCHITECT, LANDSCAPE ARCHITECT, OR LAND SURVEYOR SHALL STAMP THE DOCUMENT AND INCLUDE THE NOTATION "ALTERED BY" FOLLOWED BY THEIR SIGNATURE. THE DATE OF SUCH ALTERATION, AND A SPECIFIC DESCRIPTION OF THE ALTERATION.

CHECKED BY: B. HYDE

DRAFTED BY: T. LINDO

CHECKED BY: B. HYDE

DESIGNED BY: B. HYDE

DESIGN SUPERVISOR: C. SICHAK

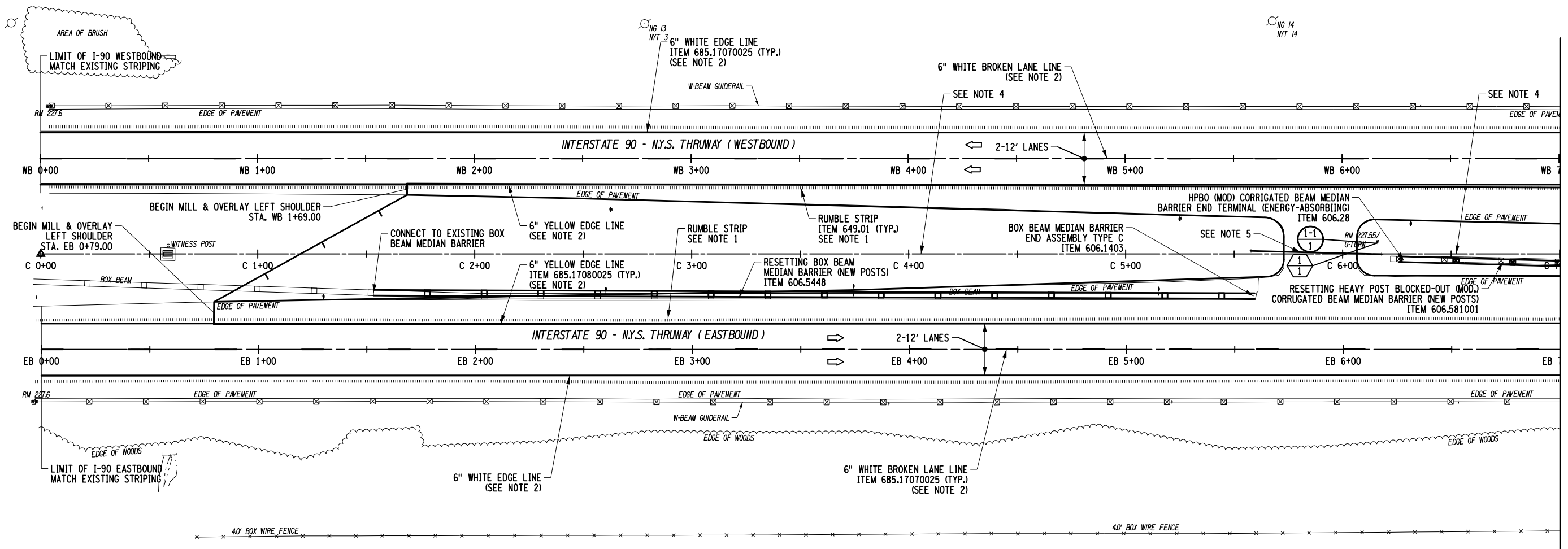

MATCH TO DRAWING NO GP-2

SIGN LEGEND	
SYMBOL	DESCRIPTION
	X - SHEET NO. NEW SIGN: Y - SIGN NO. TEXT - TEXT NO.
	SIGN REMOVAL
	RELOCATE TO POSITION SHOWN
	TO REMAIN
	EXISTING SIGN
	PROPOSED SIGN

NOTE: REFER TO DWG. MT-1 FOR SIGN TEXT DATA

NOTES:

- REFER TO NYSDOT STANDARD SHEET 649-02 FOR DETAILS OF MILLED IN AUDIBLE ROADWAY DELINEARS (MIARDS).
- UNLESS OTHERWISE NOTED, ALL MAINLINE PAVEMENT MARKINGS SHALL BE HIGHLY REFLECTORIZED TRIPLE DROP EPOXY PAVEMENT STRIPES, INCLUDING RIGHT AND LEFT EDGE LINES & BROKEN LANE LINES.
- SEE DWG. NO. MT-1 FOR GUIDERAIL TABLE & REFERENCE MARKER TABLE
- UPON COMPLETION OF CONSTRUCTION, CONTRACTOR SHALL REMOVE PROPOSED TEMPORARY MEDIAN PAVING AND RE-ESTABLISH EXISTING PRE-CONSTRUCTION GRASS MEDIAN. CONTRACTOR SHALL ENSURE POSITIVE DRAINAGE IN ACCORDANCE WITH PRE-CONSTRUCTION CONDITIONS. COST OF REMOVAL OF TEMPORARY MEDIAN PAVING, GRADING OF MEDIAN, AND ESTABLISHMENT OF TOPSOIL AND TURF TO BE INCLUDED IN ITEMS 203.02, 610.1402 AND 610.1601. SEE DETAIL ON DWG. TYP-2 A1.
- CONTRACTOR TO MILL AND OVERLAY U-TURN AREA IN SIMILAR FASHION TO DETAILS ON DWG. TYP-2 A1. CONTRACTOR TO REESTABLISH 60' CROSS CULVERT PIPE FROM STA C 5+58, 1.4' LEFT, INV. ELEV. 431.71 TO STA C 6+18, 0.1' RIGHT, INV. ELEV. 431.62. COST OF CUTTING PAVEMENT, EXCAVATION, CORRUGATED STEEL PIPE, END SECTIONS, BACKFILL AND SUBBASE, AND BINDER SHALL BE INCLUDED IN ITEMS 627.50140008, 203.02, 603.051116, 603.171116, 304.12, AND 404.197901.

14-07

FILE NAME = B2221_cph_pmp_A1.dgn
DATE/TIME = 04-JAN-2024 10:00
USER = StchakC

ALTERED ON:	AFFIXED ON: 01/04/2024
SIGNATURE: STAMP:	SIGNATURE: STAMP:

CHRISTOPHER GEORGE SICHAK
LICENSED PROFESSIONAL ENGINEER
084524

IT IS A VIOLATION OF LAW FOR ANY PERSON, UNLESS THEY ARE ACTING UNDER THE DIRECTION OF A LICENSED PROFESSIONAL ENGINEER, ARCHITECT, LANDSCAPE ARCHITECT, OR LAND SURVEYOR, TO ALTER AN ITEM IN ANY WAY. IF AN ITEM BEARING THE STAMP OF A LICENSED PROFESSIONAL IS ALTERED, THE ALTERING ENGINEER, ARCHITECT, LANDSCAPE ARCHITECT, OR LAND SURVEYOR SHALL STAMP THE DOCUMENT AND INCLUDE THE NOTATION "ALTERED BY" FOLLOWED BY THEIR SIGNATURE. THE DATE OF SUCH ALTERATION, AND A SPECIFIC DESCRIPTION OF THE ALTERATION.

REVISIONS			
DATE	DESCRIPTION	BY	SYM.

 	TITLE OF PROJECT STERLING CREEK BRIDGE REHABILITATION	CONTRACT NUMBER: TAS 24-5B
	LOCATION OF PROJECT SYRACUSE DIVISION BIN 5516091 & 5516092 MP 227.40 & MP 227.41	DATE: NOV. 2023
	TITLE OF DRAWING GENERAL PLAN	DRAWING NUMBER: GP-1

CHECKED BY: B. HYDE

DRAFTED BY: T. LINDO

CHECKED BY: B. HYDE

DESIGNED BY: B. HYDE

DESIGN SUPERVISOR: C. SICHAK

14:07

FILE NAME = B2221_cph_pmp_A1.dgn
DATE/TIME = 04-JAN-2024
USER = SICHAK

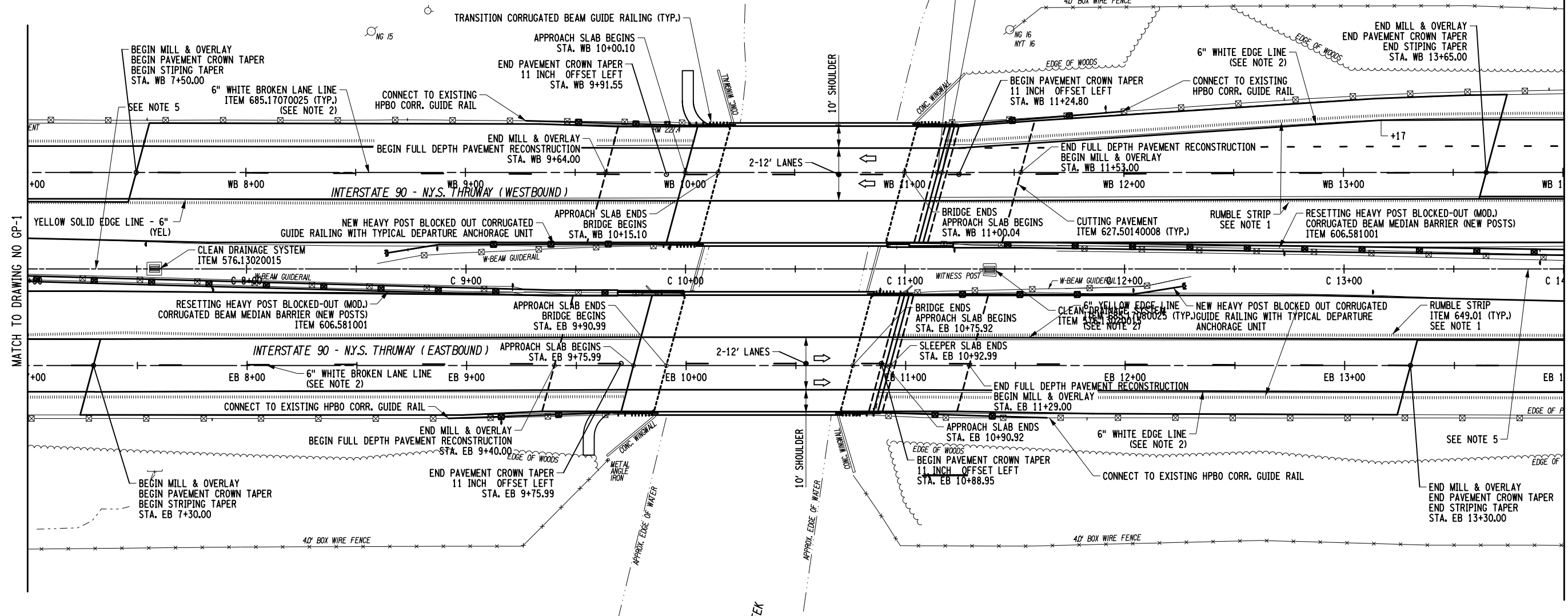
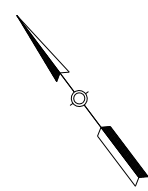

NOTES:

- REFER TO NYSDOT STANDARD SHEET 649-02 FOR DETAILS OF MILLED IN AUDIBLE ROADWAY DELINEARS (MIARDS).
- UNLESS OTHERWISE NOTED, ALL MAINLINE PAVEMENT MARKINGS SHALL BE HIGHLY REFLECTORIZED TRIPLE DROP EPOXY PAVEMENT STRIPES, INCLUDING RIGHT AND LEFT EDGE LINES & BROKEN LANE LINES.
- WHITE BROKEN LANE LINE SHALL FOLLOW CROWN TAPER AND 11" OFFSET.
- SEE DWG. NO MT-1 FOR GUIDERAIL TABLE & REFERENCE MARKER TABLE
- UPON COMPLETION OF CONSTRUCTION, CONTRACTOR SHALL REMOVE PROPOSED TEMPORARY MEDIAN PAVING AND RE-ESTABLISH EXISTING PRE-CONSTRUCTION GRASS MEDIAN. CONTRACTOR SHALL ENSURE POSITIVE DRAINAGE IN ACCORDANCE WITH PRE-CONSTRUCTION CONDITIONS. COST OF REMOVAL OF TEMPORARY MEDIAN PAVING, GRADING OF MEDIAN, AND ESTABLISHMENT OF TOPSOIL AND TURF TO BE INCLUDED IN ITEMS 203.02, 610.1402 AND 610.1601. SEE DETAIL ON DWG. TYP-2 A1.

ALTERED ON:	AFFIXED ON: 01/04/2024
SIGNATURE: STAMP:	SIGNATURE: STAMP:

CHRISTOPHER GEORGE SICHAK
LICENSED PROFESSIONAL ENGINEER
084524

IT IS A VIOLATION OF LAW FOR ANY PERSON, UNLESS THEY ARE ACTING UNDER THE DIRECTION OF A LICENSED PROFESSIONAL ENGINEER, ARCHITECT, LANDSCAPE ARCHITECT, OR LAND SURVEYOR, TO ALTER AN ITEM IN ANY WAY. IF AN ITEM BEARING THE STAMP OF A LICENSED PROFESSIONAL IS ALTERED, THE ALTERING ENGINEER, ARCHITECT, LANDSCAPE ARCHITECT, OR LAND SURVEYOR SHALL STAMP THE DOCUMENT AND INCLUDE THE NOTATION "ALTERED BY" FOLLOWED BY THEIR SIGNATURE. THE DATE OF SUCH ALTERATION, AND A SPECIFIC DESCRIPTION OF THE ALTERATION.

REVISIONS			
DATE	DESCRIPTION	BY	SYM.

 Thruway Authority 	TITLE OF PROJECT STERLING CREEK BRIDGE REHABILITATION	CONTRACT NUMBER: TAS 24-5B
	LOCATION OF PROJECT SYRACUSE DIVISION BIN 5516091 & 5516092 MP 227.40 & MP 227.41	DATE: NOV. 2023
	TITLE OF DRAWING GENERAL PLAN	DRAWING NUMBER: GP-2

MATCH TO DRAWING NO GP-1

CHECKED BY: B. HYDE

DRAFTED BY: T. LINDO

CHECKED BY: B. HYDE

DESIGNED BY: B. HYDE

DESIGN SUPERVISOR: C. SICHAK

14:08

FILE NAME = B2221_cph_pmp_A1.dgn
DATE/TIME = 04-JAN-2024
USER = S1chakC

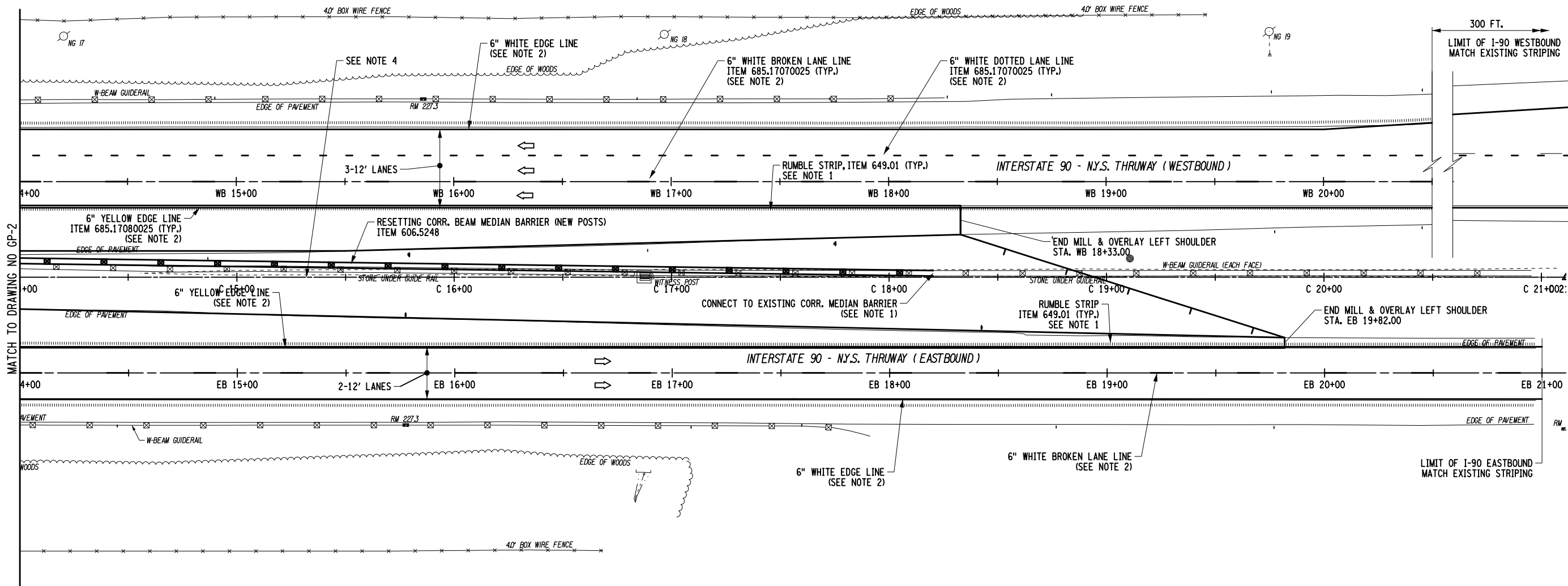

NOTES:

- REFER TO NYSDOT STANDARD SHEET 649-02 FOR DETAILS OF MILLED IN AUDIBLE ROADWAY DELINEARS (MIARDS).
- UNLESS OTHERWISE NOTED, ALL MAINLINE PAVEMENT MARKINGS SHALL BE HIGHLY REFLECTORIZED TRIPLE DROP EPOXY PAVEMENT STRIPES, INCLUDING RIGHT AND LEFT EDGE LINES & BROKEN LANE LINES.
- SEE DWG. NO. MT-1 FOR GUIDERAIL TABLE & REFERENCE MARKER TABLE
- UPON COMPLETION OF CONSTRUCTION, CONTRACTOR SHALL REMOVE PROPOSED TEMPORARY MEDIAN PAVING AND RE-ESTABLISH EXISTING PRE-CONSTRUCTION GRASS MEDIAN. CONTRACTOR SHALL ENSURE POSITIVE DRAINAGE IN ACCORDANCE WITH PRE-CONSTRUCTION CONDITIONS. COST OF REMOVAL OF TEMPORARY MEDIAN PAVING, GRADING OF MEDIAN, AND ESTABLISHMENT OF TOPSOIL AND TURF TO BE INCLUDED IN ITEMS 203.02, 610.1402 AND 610.1601. SEE DETAIL ON DWG. TYP-2 A1.

ALTERED ON:	AFFIXED ON: 01/04/2024
SIGNATURE: STAMP:	SIGNATURE: STAMP:

IT IS A VIOLATION OF LAW FOR ANY PERSON, UNLESS THEY ARE ACTING UNDER THE DIRECTION OF A LICENSED PROFESSIONAL ENGINEER, ARCHITECT, LANDSCAPE ARCHITECT, OR LAND SURVEYOR, TO ALTER AN ITEM IN ANY WAY. IF AN ITEM BEARING THE STAMP OF A LICENSED PROFESSIONAL IS ALTERED, THE ALTERING ENGINEER, ARCHITECT, LANDSCAPE ARCHITECT, OR LAND SURVEYOR SHALL STAMP THE DOCUMENT AND INCLUDE THE NOTATION "ALTERED BY" FOLLOWED BY THEIR SIGNATURE. THE DATE OF SUCH ALTERATION, AND A SPECIFIC DESCRIPTION OF THE ALTERATION.

REVISIONS			
DATE	DESCRIPTION	BY	SYM.

 Thruway Authority	TITLE OF PROJECT STERLING CREEK BRIDGE REHABILITATION	CONTRACT NUMBER: TAS 24-5B
	LOCATION OF PROJECT SYRACUSE DIVISION BIN 5516091 & 5516092, MP 227.40 & MP 227.41	DATE: NOV. 2023
	TITLE OF DRAWING GENERAL PLAN	DRAWING NUMBER: GP-3

MARK	NO.	LENGTH	TYPE	WEIGHT	A	B	C	D	E	F	G	H H1	H2	J	K K1	K2	L	O	R
EASTBOUND BEGIN ABUTMENT																			
PLACEMENT 1																			
AVG																			
5AG01	38	7'-2 1/2"	16	285.4	0'-0"	0'-0"	4'-5 1/2"	2'-9"				1'-9"			1'-9"				
LENGTH C VARIES FROM 4'-1 3/4" TO 4'-9"																			
5AG02	38	6'-3 1/2"	N1	249.3														AVG	6'-3 1/2"
LENGTH O VARIES FROM 5'-0" TO 6'-7"																			
5AG03	38	6'-10 3/4"	17	273.0		2'-1"	2'-1 1/2"	2'-8"											
8AG04	6	55'-5 1/4"	N1	888.2														55'-5 1/4"	
SUBTOTAL GALVANIZED BARS				1695.9	LBS THIS POUR														
PLACEMENT 2																			
5AG05	8	59'-2"	N1	493.7														59'-2"	
5AG06	41	3'-2"	17	135.4		1'-0"	1'-2"	1'-0"											
5AG07	4	5'-10 1/4"	N12	24.4		2'-9"	3'-1 1/4"	0'-0"				0'-5 3/4"			3'-0"				
5AG08	4	4'-7 3/4"	N12	19.4		2'-9"	1'-10 3/4"	0'-0"				0'-6"			1'-10"				
5AG11	6	6'-7"	N1	41.1														6'-7"	
SUBTOTAL GALVANIZED BARS				714.1	LBS THIS POUR														
PLACEMENT 3																			
5AG12	8	2'-4 1/4"	17	19.6		0'-6"	1'-10 1/4"	0'-0"											
5AG13	8	2'-5 3/4"	17	20.8		0'-6"	1'-11 3/4"	0'-0"											
5AG14	8	2'-7 1/2"	17	21.9		0'-6"	2'-1 1/2"	0'-0"											
5AG15	8	2'-9"	17	22.9		0'-6"	2'-3"	0'-0"											
5AG16	8	2'-10 1/4"	17	23.8		0'-6"	2'-4 1/4"	0'-0"											
5AG17	8	2'-9 3/4"	17	23.5		0'-6"	2'-3 3/4"	0'-0"											
5AG18	8	2'-8 1/4"	17	22.4		0'-6"	2'-2 1/4"	0'-0"											
5AG19	8	2'-5 3/4"	17	20.7		0'-6"	1'-11 3/4"	0'-0"											
5AG20	15	10'-0"	T1	156.5	0'-5 1/2"	2'-7"	1'-11 1/2"	2'-7"	1'-11 1/2"			0'-5 1/2"			0'-3 3/4"				
SUBTOTAL GALVANIZED BARS				332.1	LBS THIS POUR														
EASTBOUND END ABUTMENT																			
PLACEMENT 1																			
AVG																			
5AG01	38	7'-9 3/4"	16	309.3	0'-0"	0'-0"	5'-0 3/4"	2'-9"				1'-9"			1'-9"				
LENGTH C VARIES FROM 4'-9" TO 5'-4 1/4"																			
5AG02	38	6'-9 1/2"	N1	269.1		6'-6"	7'-1"											AVG	6'-9 1/2"
LENGTH O VARIES FROM 6'-6" TO 7'-1"																			
5AG03	38	7'-10 1/4"	17	311.1		2'-6 3/4"	2'-1 1/2"	3'-1 3/4"											
8AG04	6	55'-5 1/4"	N1	888.2														55'-5 1/4"	
SUBTOTAL GALVANIZED BARS				1777.6	LBS THIS POUR														
PLACEMENT 2																			
5AG05	8	59'-2"	N1	493.7														59'-2"	
5AG06	41	3'-2"	17	135.4		1'-0"	1'-2"	1'-0"											
5AG09	4	5'-10 1/4"	N12	24.4		0'-0"	3'-1 1/4"	2'-9"				0'-5 3/4"			3'-0"				
5AG10	4	4'-7 3/4"	N12	19.4		0'-0"	1'-10 3/4"	2'-9"				0'-6"			1'-10"				
5AG11	6	7'-1"	N1	44.3														7'-1"	
SUBTOTAL GALVANIZED BARS				717.2	LBS THIS POUR														

MARK	NO.	LENGTH	TYPE	WEIGHT	A	B	C	D	E	F	G	H H1	H2	J	K K1	K2	L	O	R
EASTBOUND END ABUTMENT CONT.																			
PLACEMENT 3																			
5AG12	8	2'-4 1/4"	17	19.6		0'-6"	1'-10 1/4"	0'-0"											
5AG13	8	2'-5 3/4"	17	20.8		0'-6"	1'-11 3/4"	0'-0"											
5AG14	8	2'-7 1/2"	17	21.9		0'-6"	2'-1 1/2"	0'-0"											
5AG15	8	2'-9"	17	22.9		0'-6"	2'-3"	0'-0"											
5AG16	8	2'-10 1/4"	17	23.8		0'-6"	2'-4 1/4"	0'-0"											
5AG17	8	2'-9 3/4"	17	23.5		0'-6"	2'-3 3/4"	0'-0"											
5AG18	8	2'-8 1/4"	17	22.4		0'-6"	2'-2 1/4"	0'-0"											
5AG19	8	2'-5 3/4"	17	20.7		0'-6"	1'-11 3/4"	0'-0"											
5AG20	15	10'-0"	T1	156.5	0'-5 1/2"	2'-7"	1'-11 1/2"	2'-7"	1'-11 1/2"			0'-5 1/2"			0'-3 3/4"				
SUBTOTAL GALVANIZED BARS				332.1	LBS THIS POUR														
EASTBOUND SUPERSTRUCTURE SLAB																			
4SG01	132	57'-9 3/4"	N1	5097.9															57'-9 3/4"
4SG02	160	60'-0"	N1	6412.8															60'-0"
4SG03	160	26'-4 1/4"	N1	2815.9															26'-4 1/4"
5SG04	12	60'-0"	N1	751.0															60'-0"
5SG05	12	28'-3 1/4"	N1	353.7															28'-3 1/4"
4SG06	132	7'-6 1/2"	1	665.0	0'-6"	7'-0 1/2"						0'-0"			0'-4"				
4SG07	132	51'-3 1/2"	1	4522.7	0'-6"	50'-9 1/2"						0'-0"			0'-4"				
6SG08	264	5'-10 1/2"	1	2329.6	0'-8"	5'-2 1/2"						0'-0"			0'-6"				
5SG09	242	2'-10"	N1	715.2															2'-10"
6SG10	178	4'-5"	19	1180.8	1'-0"	3'-5"	0'-0"					0'-11 3/4"	0'-0"		0'-2 1/4"	0'-0"			3'-7 1/4"
AVG																			
6SG11	64	4'-5"	19	424.6		1'-0"	3'-5"	0'-0"				0'-11 3/4"	0'-0"		0'-1"	0'-0"			3'-6"
LENGTH H VARIES FROM 0'-11 3/4" TO 1'-0"																			
LENGTH K VARIES FROM 0'-0" TO 0'-2 1/4"																			
7SG12	20	5'-8 3/4"	14	234.6	2'-8 1/2"	0'-6 1/4"	2'-6"	0'-0"	0'-0"			0'-4 1/2"	0'-0"		0'-4 1/2"	0'-0"			0'-6"
5SG13	20	6'-5 1/2"	S11	134.6									2'-10"						
5SG14	20	3'-8 1/2"	1	77.4	0'-7"	3'-1 1/2"									0'-5"				
4SG15	166	7'-0"	1	776.2	0'-6"	6'-0"						0'-6"			0'-4"				
4SG16	8	3'-5 1/4"	16	18.4	0'-0"	0'-0"	1'-5"	2'-0 1/4"				1'-5 1/4"			1'-5 1/4"				2'-10 1/4"
4SG17	14	3'-2 1/2"	N8	30.0		0'-9"	0'-4"	1'-0 1/2"	0'-4"	0'-9"									2'-6 1/2"
SUBTOTAL GALVANIZED BARS				26540.3	LBS THIS POUR														
EASTBOUND BEGIN APPROACH SLAB																			
5HG01	166	14'-6"	N1	2510.5															14'-6"
5HG02	32	54'-2 1/4"	N1	1808.9															54'-2 1/4"
5HG03	8	4'-9"	N11	39.6		0'-0"	0'-0"	2'-0"	0'-9"	2'-0"		1'-5"	1'-5"		0'-0"	1'-5"	0'-0"		3'-7"
SUBTOTAL GALVANIZED BARS				4359.0	LBS THIS POUR														
EASTBOUND END APPROACH SLAB																			
5HG01	166	14'-6"	N1	2510.5															14'-6"
5HG02	32	54'-2 1/4"	N1	1808.9															54'-2 1/4"
5HG03	8	4'-9"	N11	39.6		0'-0"	0'-0"	2'-0"	0'-9"	2'-0"		1'-5"	1'-5"		0'-0"	1'-5"	0'-0"		3'-7"
SUBTOTAL GALVANIZED BARS				4359.0	LBS THIS POUR														
EASTBOUND SLEEPER SLAB																			
5HG11	112	5'-6"	N1	642.5															5'-6"
5HG12	17	54'-2 1/4"	N1	961.0															54'-2 1/4"
5HG13	56	4'-6"	17	262.8		1'-6"	1'-6"	1'-6"											
SUBTOTAL GALVANIZED BARS				1866.3	LBS THIS POUR														
EASTBOUND BARRIER																			
7BG01	24	60'-0"	N1	2943.4															60'-0"
7BG02	24	29'-2 1/4"	N1	1431.5															29'-2 1/4"
5BG03	178	6'-5 3/4"	13	1202.9		2'-11 1/4"	0'-8 3/4"	2'-9 3/4"				0'-0"	1'-1 1/2"	0'-0"	2'-10 1/2"	0'-7 1/2"	3'-0 3/4"		0'-3"
AVG																			
5BG04	64	6'-5 1/4"	13	429.7		2'-10 1/2"	0'-9"	2'-9 3/4"				0'-0"	0'-5 3/4"	0'-0"	2'-10"	0'-3 3/4"	3'-0 3/4"		0'-3"
LENGTH K VARIES FROM 2'-9 3/4" TO 2'-10 1/2"																			
LENGTH L VARIES FROM 0'-0" TO 0'-7 1/2"																			
5BG05	20	5'-1 1/2"	S11	106.8									2'-2"						0'-6"
SUBTOTAL GALVANIZED BARS				6114.2	LBS THIS POUR														

CHECKED BY: M. YAEGER

DRAFTED BY: T. LINDO

CHECKED BY: M. YAEGER

DESIGNED BY: M. YAEGER

DESIGN SUPERVISOR: C. SICHAK

ALTERED ON: _____ AFFIXED ON: 01/04/2024

SIGNATURE: _____ STAMP: _____



IT IS A VIOLATION OF LAW FOR ANY PERSON, UNLESS THEY ARE ACTING UNDER THE DIRECTION OF A LICENSED PROFESSIONAL ENGINEER, ARCHITECT, LANDSCAPE ARCHITECT, OR LAND SURVEYOR, TO ALTER AN ITEM IN ANY WAY. IF AN ITEM BEARING THE STAMP OF A LICENSED PROFESSIONAL IS ALTERED, THE ALTERING ENGINEER, ARCHITECT, LANDSCAPE ARCHITECT, OR LAND SURVEYOR SHALL STAMP THE DOCUMENT AND INCLUDE THE NOTATION "ALTERED BY" FOLLOWED BY THEIR SIGNATURE. THE DATE OF SUCH ALTERATION, AND A SPECIFIC DESCRIPTION OF THE ALTERATION.

REVISIONS			
DATE	DESCRIPTION	BY	SYM.

NEW YORK STATE OF OPPORTUNITY | **Thruway Authority**

ERDMAN ANTHONY

TITLE OF PROJECT: STERLING CREEK BRIDGE REHABILITATION
 LOCATION OF PROJECT: SYRACUSE DIVISION
 BIN 5516091 & 5516092 MP 227.40 & MP 227.41
 TITLE OF DRAWING: BAR LIST (1 OF 2)

CONTRACT NUMBER: TAS 24-5B
 DATE: NOV. 2023
 DRAWING NUMBER: ST-41

