

**NEW YORK STATE THRUWAY AUTHORITY  
DEPARTMENT OF ENGINEERING**

**ALBANY, NY  
MARCH 7, 2024**

**AMENDMENT NO. 1  
TO**

**CONTRACT TANY 24-10  
D214962  
PAVEMENT REHABILITATION, MILL AND INLAY,  
SAFETY IMPROVEMENTS AND MISCELLANEOUS WORK  
BETWEEN MILEPOST 24.0 AND MILEPOST 29.4  
IN THE NEW YORK DIVISION  
OF THE NEW YORK STATE THRUWAY  
IN ROCKLAND COUNTY**

**IN THE LETTING OF**

**MARCH 13, 2024**

---

**NOTE:** This amendment shall be attached to and become a part of the Proposal for Contract **TANY 24-10**.

**NOTICE**

For Electronic Bidders, the Project's amended EBSX file will automatically account for any necessary item changes (deletions, changes in quantities, or additions) that this Amendment may describe as being required regarding the project's estimated cost. Instructions to make physical changes to the Project Proposal's bid sheets are intended for "paper" Bidders who choose to submit bids via paper.

Questions and Answers for this project are available from the Authority's website, specifically at: [http://www.thruway.ny.gov/netdata/contractors/documents/d214962\\_tany24-10\\_questions-and-answers-03-07-2024.pdf](http://www.thruway.ny.gov/netdata/contractors/documents/d214962_tany24-10_questions-and-answers-03-07-2024.pdf). This document may be updated periodically without formal issuance of an Amendment. Prospective bidders are advised to revisit this link weekly and before proposals are due, for any possible additional questions and answers information.

Similarly, additional Supplemental Information for this project is not presently available from the Authority's website. However, it is anticipated that revised quantity workups may be provided as new and additional supplemental information, but after the issuance of this Amendment. Prospective bidders are advised to revisit the website weekly and before proposals are due, for any possible additional supplemental information.

**PROPOSAL**

1. **DELETE** the following Items:

<u>Contract Proposal Page</u>	<u>Item No.</u>	<u>Description</u>	<u>Unit</u>	<u>Estimated Quantity</u>
183	603.171614	Galvanized Steel End Section - Pipe ( 2-2/3"X1/2" Corrugations ) 30 Inches Diameter, 14 Gauge	EA	1
184	603.9824	Smooth Interior Corrugated Polyethylene Culvert Storm Drain 24" Diameter	LF	20

The “paper” Bidder shall **CROSS OUT** and not enter a bid for these items in the Contract Proposal. If the Bidder fails to make these changes, the Authority will do so and adjust the TOTAL BID, accordingly.

**DELETE** all other references to the above items in the Contract Plans and Contract Proposal.

2. **ADD** the following Items:

<u>Contract Proposal Page</u>	<u>Item No.</u>	<u>Description</u>	<u>Unit</u>	<u>Estimated Quantity</u>
191A-A1	603.171814	Galvanized Steel End Sections-Pipe (2-2/3" X 1/2" Corrugations) 36 Inch Diameter, 14 Gauge	EA	1
191A-A1	603.9830	Smooth Interior Corrugated Polyethylene Culvert and Storm Drain 30 Inch Diameter	LF	8

The “paper” Bidder must **RETURN THE ATTACHED PAGE 191A-A1** with its bid for this Contract.

3. On Contract Proposal (and Bid Proposal) pages numbered 1 and 179, and in all other locations in the Contract Proposal, **CHANGE** the COMPLETION DATE to **November 29, 2024**.

**PLANS**

4. **DELETE** Drawing Number MSD-04, Sheet 26 of 58, and **SUBSTITUTE** with the attached Drawing Number MSD-04, Sheet 26-A1 of 58. The Special Cast-In-Place Transition Detail – Item 606.26500108 has been updated with revised dimensions for the existing width. The reinforcement bar list table has also been updated.
5. **DELETE** Drawing Number GNP-02, Sheet 31 of 58, and **SUBSTITUTE** with the attached Drawing Number GNP-02, Sheet 31-A1 of 58. References to (new) Item 603.171814 and (new) Item 603.9830 have been added for the slope flattening and culvert extension location. Previous references to (old) Item 603.171614 and (old) Item 603.9824 have been removed.

6. **DELETE** Drawing Number GNP-25, Sheet 54 of 58, and **SUBSTITUTE** with the attached Drawing Number GNP-25, Sheet 54-A1 of 58. The proposed guiderail line was shifted to a correct location and the (revised) Special Cast-In-Place Transition piece is now shown.
7. **DELETE** Drawing Number GNP-26, Sheet 55 of 58, and **SUBSTITUTE** with the attached Drawing Number GNP-26, Sheet 55-A1 of 58. The proposed guiderail line was shifted to its correct location.

The Bidder **MUST** complete **Page 205** of the Proposal acknowledging receipt of this amendment. If the Bidder fails to complete the “Amendment Acknowledgement” sheet, his bid could be declared informal thereby delaying award of the contract.

**PLEASE BE GOVERNED ACCORDINGLY WHEN SUBMITTING BIDS.**

**Brent Howard, P.E.**  
**Chief Engineer**



03/07/2024 10:27:04 AM

AASHTOWare Project™ Version 5.00 Revision 031

**Proposal Schedule of Items**

**Proposal ID:** D214962

**Project(s):** N72282

**Contractor:** \_\_\_\_\_

**SECTION:** 0001                      SECTION 1

**Alt Set ID:**                                      **Alt Mbr ID:**

Proposal Line Number	Item ID Description	Approximate Quantity and Units	Unit Price		Bid Amount	
			Dollars	Cents	Dollars	Cents
0300	603.171814 GALVANIZED STEEL END SECTION PIPE (2-2/3 INCH X 1/2 INCH CORRUGATIONS) 36 INCH DIAMETER, 14 GAUGE	1.000 EACH	_____.	_____.	_____.	_____.
0302	603.9830 SMOOTH INTERIOR CORRUGATED POLYETHYLENE CULVERT AND STORM DRAIN 30 INCH DIAMETER	8.000 LF	_____.	_____.	_____.	_____.
<b>Section: 0001</b>			<b>Total:</b>		_____.	
			<b>Total Bid:</b>		_____.	

Plotted By: ngercio D214812-H1391.1.cph.med.04 REV.dgn Design File: 6/4/2024 6:46:50 PM  
 Checked By: S. SCIOTTO  
 Drafted By: N. GONZALEZ GARCIA  
 Design Supervisor: S. SCIOTTO

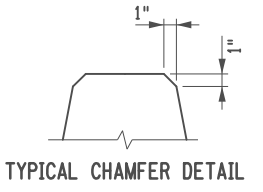
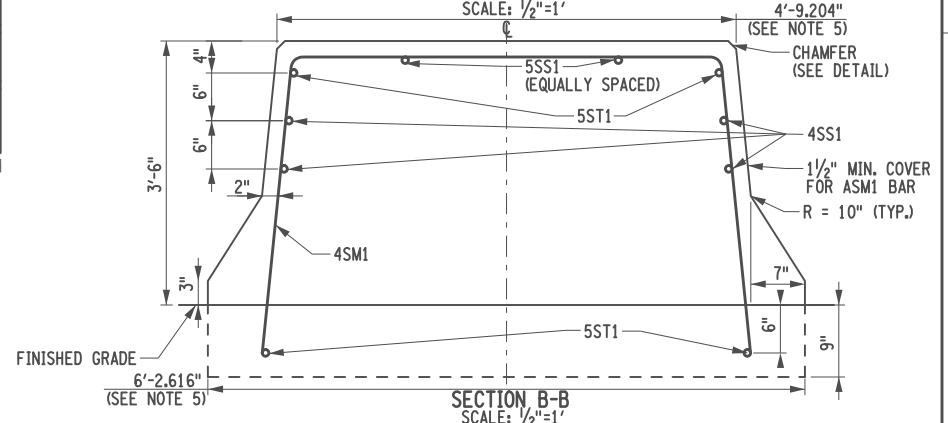
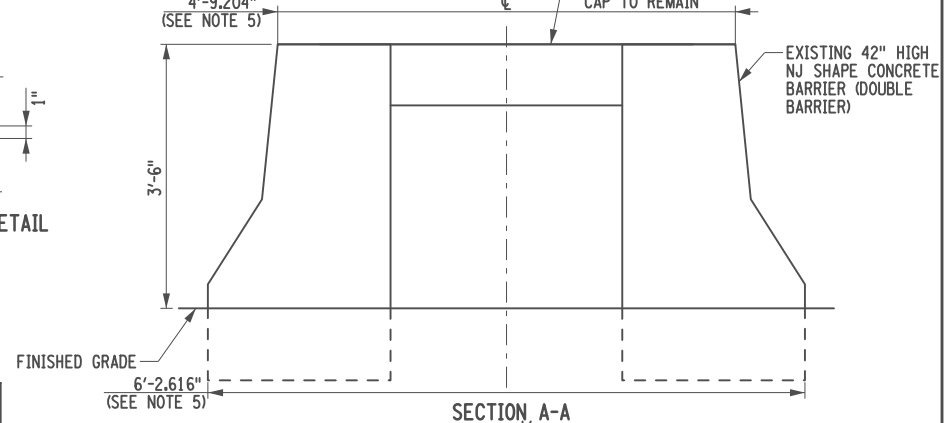
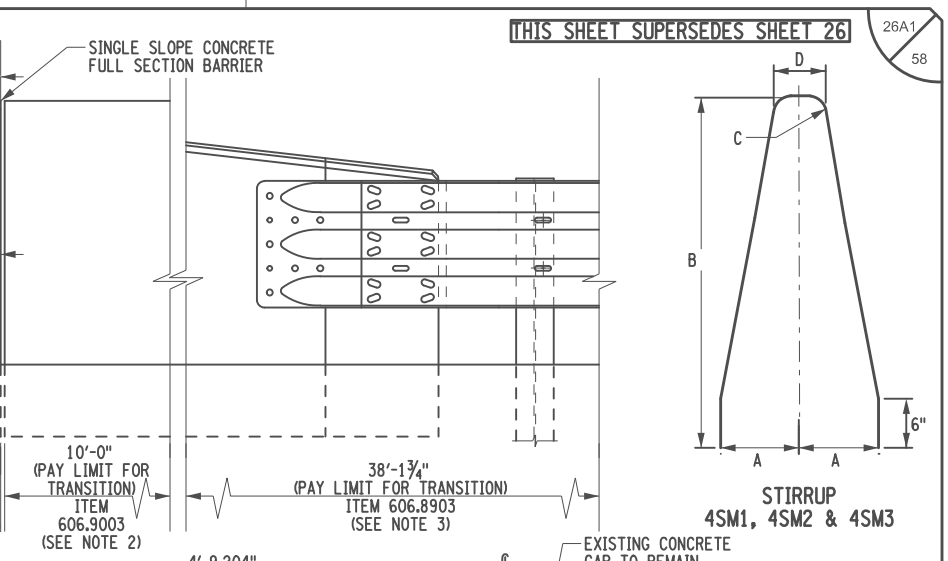
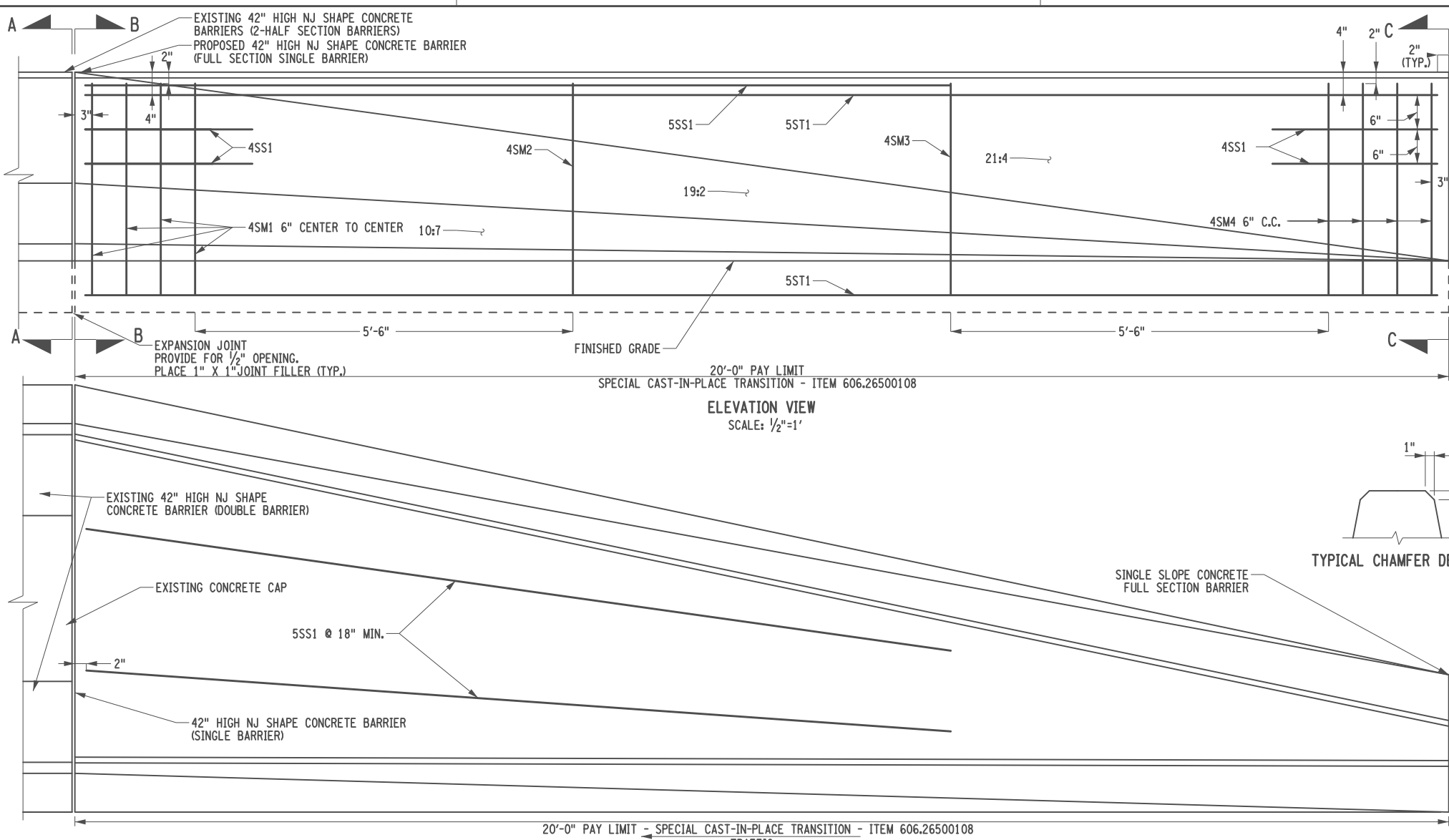

BAR LIST									
MARK	SIZE	NO.	LENGTH	USE	A	B	C	D	LOCATION
4SS1	#4	8	2'-6"	STRAIGHT					4 AT EACH END OF TRANSITION
4SM1	#4	4	VARIES 10'-7" TO 10'-1"	STIRRUP	VARIES 2'-6 1/2" TO 2'-3"	3'-10"	1 1/2"	VARIES 4 1/2"-3'11 1/2"	4 AT 6" CENTERS AT NJ CONCRETE BARRIER END
4SM2	#4	1	8'-11"	STIRRUP	1'-7"	3'-10"	1 1/2"	2'-9"	AS SHOWN IN ELEVATION VIEW
4SM3	#4	1	8'-2"	STIRRUP	1'-2"	3'-10"	1 1/2"	2'-1"	AS SHOWN IN ELEVATION VIEW
4SM4	#4	4	VARIES 6'-11" TO 6'-8"	STIRRUP	VARIES 1'-1.7" TO 10.2"	3'-10"	1 1/2"	VARIES 7" TO 5.2"	4 AT 6" CENTERS AT SINGLE SLOPE BARRIER END
5ST1	#5	4	19'-8"	STRINGER					LONGITUDINAL 2 IN TOP 2 IN BOTTOM
5SS1	#5	2	VARIES 12'-7 1/2" TO 12'-8 1/2"	STRAIGHT					TOP LONGITUDINAL 2 IN TOP

- TRAFFIC PLAN VIEW**  
SCALE: 1/2"=1'
- SPECIAL CAST-IN-PLACE TRANSITION DETAIL - ITEM 606.26500108**
- NOTES:**
- BENDING OF BOTTOM OF STIRRUPS SHOWN IN SECTION C-C IS NOT NECESSARY PROVIDED COVER REQUIREMENTS ARE SATISFIED.
  - UTILIZE THE NYSDOT STANDARD SHEET 606-32, TRANSITION: HALF-SECTION TO FULL-SECTION SINGLE SLOPE CONCRETE BARRIER, AS REFERENCE FOR ITEM 606.9003.
  - UTILIZE THE NYSDOT STANDARD SHEET 606-28, TRANSITION: HPBO (MOD.) - SINGLE SLOPE HALF SECTION AS REFERENCE FOR NYSTA ITEM 606.8903.
  - PROVIDE 2" MIN. COVER FOR ALL REINFORCEMENT UNLESS OTHERWISE NOTED.
  - THE INTENT OF THE PROPOSED CONSTRUCTION IS TO MATCH THE DIMENSIONS OF THE EXISTING 42" NJ SHAPE BARRIER AT THE BEGINNING OF THE TRANSITION. THE CONTRACTOR SHALL VERIFY ALL EXISTING DIMENSIONS PRIOR BEGINNING WORK AND REPORT ANY DIMENSIONAL VARIATION OR DISCREPANCIES WITH THE DIMENSIONS SHOWN HEREON TO THE ENGINEER.
  - ALL CONCRETE SURFACES SHALL BE SMOOTH.
  - MATERIALS SHALL CONFORM TO NYSDOT STANDARD SPECIFICATION 606.-2.14, TRANSITIONS CONSTRUCTED OF, OR WITH CONCRETE.
  - MATERIALS SHALL CONFORM TO NYSDOT STANDARD SPECIFICATION 606-3.19, TRANSITIONS CONSTRUCTED OF, OR WITH CONCRETE.
  - THE CONTRACTOR SHALL ENSURE NO VOIDS ARE PRESENT IN BETWEEN THE EXISTING BARRIER HALF SECTIONS AFTER IT IS CUT FOR REMOVAL. EXISTING FILL MATERIAL BETWEEN THE TWO EXISTING HALF SECTION BARRIER PIECES MAY BE REMOVED TO ALLOW WORK IN THE AREA AND TO PREVENT SPILLING OF THE FILL MATERIAL WHEN THE SECTIONS ARE CUT. THE CONTRACTOR MUST REPLACE ANY FILL MATERIAL AFTER THE INSTALLATION OF THE NEW TRANSITION PIECES TO PREVENT ANY VOIDS.

ALTERED ON: \_\_\_\_\_ AFFIXED ON: 03/06/2024

SIGNATURE: \_\_\_\_\_ STAMP: \_\_\_\_\_

SIGNATURE: \_\_\_\_\_ STAMP: \_\_\_\_\_

ITEM	DESCRIPTION	UNIT
606.26500108	SPECIAL CAST-IN-PLACE TRANSITION	EA
606.2701	HEAVY POST BLOCK-OUT (MOD.) CORRUGATED BEAM GUIDE RAILING	LF
606.8903	TRANSITION - HPBO (MOD.) CORRUGATED BEAM GUIDE RAILING TO SINGLE SLOPE CONCRETE HALF SECTION BARRIER	EA
606.9003	TRANSITION - HALF-SECTION AND FULL-SECTION SINGLE SLOPE CONCRETE BARRIER (LEFT POCKET)	EA

IT IS A VIOLATION OF LAW FOR ANY PERSON, UNLESS THEY ARE ACTING UNDER THE DIRECTION OF A LICENSED PROFESSIONAL ENGINEER, ARCHITECT, LANDSCAPE ARCHITECT, OR LAND SURVEYOR, TO ALTER AN ITEM IN ANY WAY. IF AN ITEM BEARING THE STAMP OF A LICENSED PROFESSIONAL IS ALTERED, THE ALTERING ENGINEER, ARCHITECT, LANDSCAPE ARCHITECT, OR LAND SURVEYOR SHALL STAMP THE DOCUMENT AND INCLUDE THE NOTATION "ALTERED BY" FOLLOWED BY THEIR SIGNATURE, THE DATE OF SUCH ALTERATION, AND A SPECIFIC DESCRIPTION OF THE ALTERATION.

REVISIONS			
DATE	DESCRIPTION	BY	SYL

**NEW YORK STATE OF OPPORTUNITY** | **Thruway Authority**

**HE Hayduk Engineering, LLC**

TITLE OF PROJECT: PAVEMENT REHABILITATION AND SAFETY IMPROVEMENTS  
 LOCATION OF PROJECT: NEW YORK DIVISION MP 24.0 TO 29.4  
 TITLE OF DRAWING: MISCELLANEOUS DETAILS SHEET 4 OF 5

CONTRACT NUMBER: TANY 24-10  
 DATE: 2/2/2024  
 DRAWING NUMBER: MSD-04

PLOTTED BY: USRW09220 0214812-H1391-1.cph\_gnp\_02.dgn  
 DESIGN FILE: 06-MAR-2024 16:19  
 CHECKED BY: F.COSTANZO  
 DRAFTED BY: R.MOHABIR  
 DESIGNED BY: K.CZORA  
 DESIGN SUPERVISOR: B.LAGRAVE

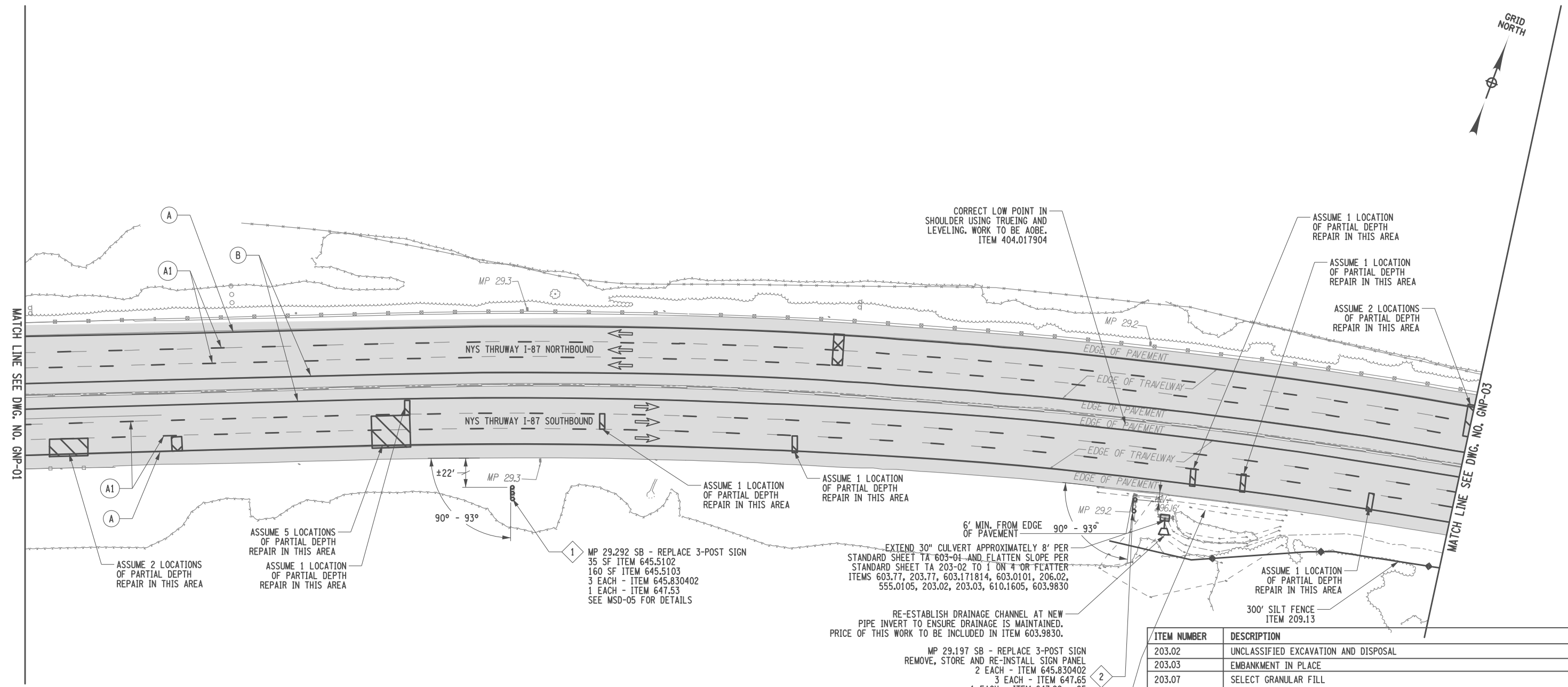

**STRIPING LEGEND**

SYMBOL	LINE TYPE	ITEM NUMBER	DESCRIPTION
A	6" WHITE EDGE LINE		WHITE HIGHLY REFLECTORIZED TRIPLE DROP EPOXY PAVEMENT STRIPES 6 INCH WIDTH X 20 MILS
A1	6" WHITE BROKEN LANE LINE	685.1707 25	
B	6" YELLOW EDGE LINE	685.1708 25	YELLOW HIGHLY REFLECTORIZED TRIPLE DROP EPOXY PAVEMENT STRIPES 6 INCH WIDTH X 20 MILS
	NOT APPLICABLE	635.04030225	RECESS DIAMOND GRINDING FOR INLAID PAVEMENT MARKINGS

**LEGEND:**

- XX - GUIDE RAIL WORK LOCATION
- ⊖ - STRIPING TYPE ⊖ - SIGN WORK LOCATION
- - 2" MILL AND INLAY LOCATIONS
- ▨ - PARTIAL DEPTH REPAIR
- ▩ - FULL DEPTH REPAIR

**NOTES:**

- UTILIZE THE NYSTA STANDARD SHEETS TA 619-08 AND TA 619-09 TO PROGRESS THE MAINLINE WORK. UTILIZE THE SUCCESSIVE WORKSPACES OCCUPYING THE SAME LANE DETAIL ON STANDARD SHEET TA 619-17 WHILE PERFORMING THE FULL AND PARTIAL DEPTH REPAIRS.
- REFER TO DRAWING TC-2 TO TC-3 FOR WORK ZONE TRAFFIC CONTROL TYPICAL SECTIONS AND ADDITIONAL WORK ZONE TRAFFIC CONTROL NOTES.
- FOR FULL AND PARTIAL DEPTH REPAIR LOCATIONS AND DETAILS REFER TO DWG. NO. MST-01, TA STANDARD SHEET 402-01 AND MSD-01.

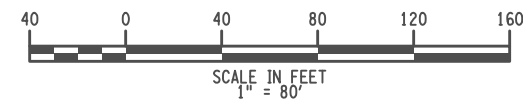

ITEM NUMBER	DESCRIPTION
203.02	UNCLASSIFIED EXCAVATION AND DISPOSAL
203.03	EMBANKMENT IN PLACE
203.07	SELECT GRANULAR FILL
206.0201	TRENCH AND CULVERT EXCAVATION
209.13	SILT FENCE - TEMPORARY
404.017901	TRUEING & LEVELING F9, ASPHALT, 70 SERIES COMPACTION
555.0105	CONCRETE FOR STRUCTURES, CLASS A
603.0101	CULVERT-END SAFETY GRATE
603.171814	GALVANIZED STEEL END SECTION PIPE (2-2/3 INCH X 1/2 INCH CORRUGATIONS) 36 INCH DIAMETER, 14 GAUGE
603.77	CONCRETE COLLARS
603.9830	SMOOTH INTERIOR CORRUGATED POLYETHYLENE CULVERT AND STORM DRAIN 30 INCH DIAMETER
610.1605	TURF ESTABLISHMENT PERFORMANCE
645.5102	GROUND MOUNTED SIGN PANELS, LESS THAN OR EQUAL TO 30 SF, WITH Z-BARS
645.5103	GROUND-MOUNTED SIGN PANELS GREATER THAN 30 SF WITH Z-BARS
645.830402	TYPE B SIGN POST, GALVANIZED, W8x15 SECTION, BI-DIRECTIONAL BREAKAWAY BASE
647.53	REMOVE AND DISPOSE SIGN PANEL, SIGN PANEL ASSEMBLY SIZE III (OVER 100 SQUARE FT.)
647.9900025	REMOVING STORING AND REINSTALLING SIGNS
647.65	REMOVE AND DISPOSE TYPE B GROUND MOUNTED SIGN SUPPORT AND FOUNDATION



IT IS A VIOLATION OF LAW FOR ANY PERSON, UNLESS THEY ARE ACTING UNDER THE DIRECTION OF A LICENSED PROFESSIONAL ENGINEER, ARCHITECT, LANDSCAPE ARCHITECT, OR LAND SURVEYOR, TO ALTER AN ITEM IN ANY WAY. IF AN ITEM BEARING THE STAMP OF A LICENSED PROFESSIONAL IS ALTERED, THE ALTERING ENGINEER, ARCHITECT, LANDSCAPE ARCHITECT, OR LAND SURVEYOR SHALL STAMP THE DOCUMENT AND INCLUDE THE NOTATION "ALTERED BY" FOLLOWED BY THEIR SIGNATURE, THE DATE OF SUCH ALTERATION, AND A SPECIFIC DESCRIPTION OF THE ALTERATION.

REVISIONS			
DATE	DESCRIPTION	BY	SYMBOL

TITLE OF PROJECT: PAVEMENT REHABILITATION AND SAFETY IMPROVEMENTS LOCATION OF PROJECT: NEW YORK DIVISION MP 24.0 TO 29.4	CONTRACT NUMBER: TANY 24-10 DATE: 2/2/2024
TITLE OF DRAWING: GENERAL PLANS DRAWING NUMBER: GNP-02	

PLOTTED BY: USRM09220 0214812-HI1391-1.cph\_gnp\_25.dgn  
 DESIGN FILE: 06-MAR-2024 16:19  
 CHECKED BY: F.COSTANZO  
 DRAFTED BY: R.MOHABIR  
 CHECKED BY: F.COSTANZO  
 DESIGNED BY: K.CZORA  
 DESIGN SUPERVISOR: B.LAGRAVE

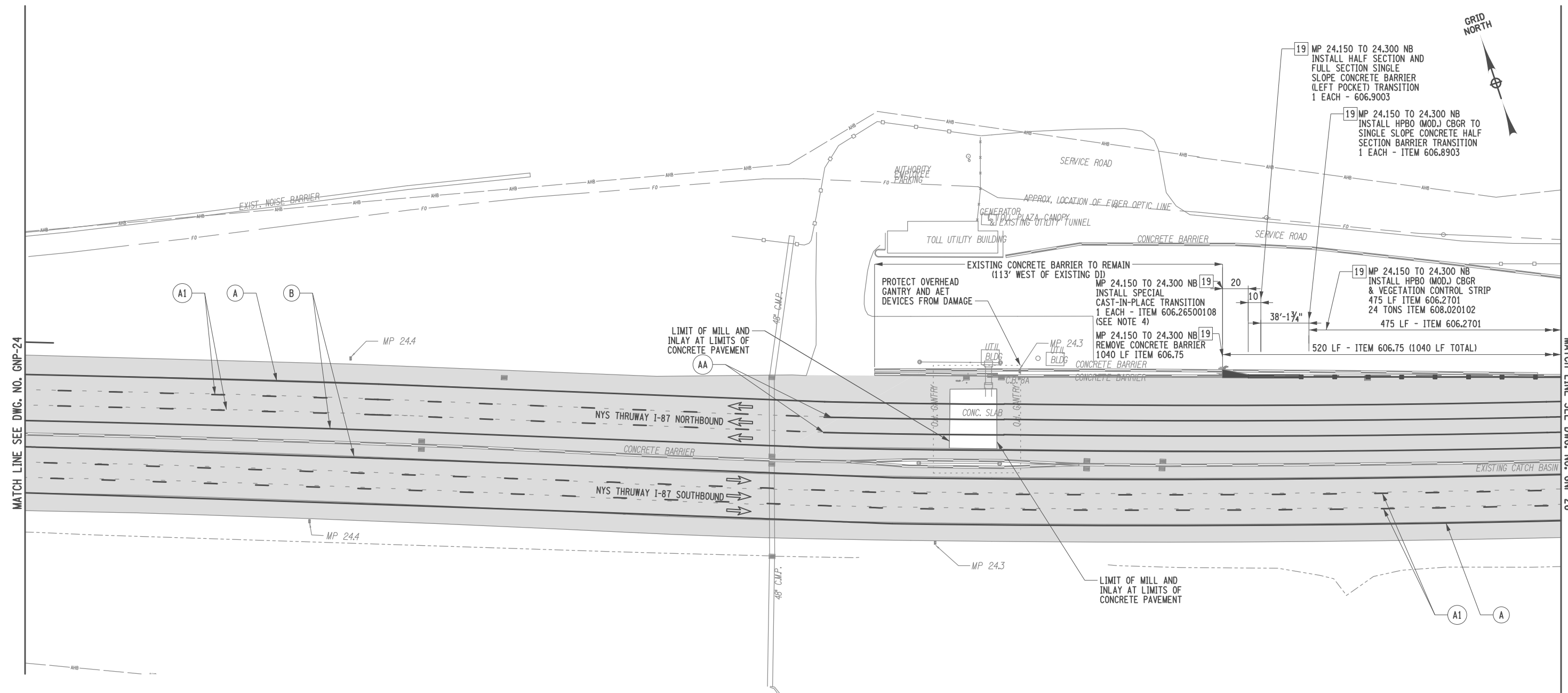

STRIPING LEGEND			
SYMBOL	LINE TYPE	ITEM NUMBER	DESCRIPTION
A	6" WHITE EDGE LINE		WHITE HIGHLY REFLECTORIZED TRIPLE DROP EPOXY PAVEMENT STRIPES 6 INCH WIDTH X 20 MILS
AA	6" WHITE LANE LINE	685.1707 25	WHITE HIGHLY REFLECTORIZED TRIPLE DROP EPOXY PAVEMENT STRIPES 6 INCH WIDTH X 20 MILS
A1	6" WHITE BROKEN LANE LINE		WHITE HIGHLY REFLECTORIZED TRIPLE DROP EPOXY PAVEMENT STRIPES 6 INCH WIDTH X 20 MILS
B	6" YELLOW EDGE LINE	685.1708 25	YELLOW HIGHLY REFLECTORIZED TRIPLE DROP EPOXY PAVEMENT STRIPES 6 INCH WIDTH X 20 MILS
NOT APPLICABLE		635.04030225	RECESS DIAMOND GRINDING FOR INLAID PAVEMENT MARKINGS

- LEGEND:**
- XX - GUIDE RAIL WORK LOCATION
  - XX - STRIPING TYPE
  - - 2" MILL AND INLAY LOCATIONS
  - ▨ - PARTIAL DEPTH REPAIR
  - ▩ - FULL DEPTH REPAIR

- NOTES:**
- UTILIZE THE NYSTA STANDARD SHEETS TA 619-08, TA 619-09 AND 619-27 TO PROGRESS THE MAINLINE WORK. UTILIZE THE SUCCESSIVE WORKSPACES OCCUPYING THE SAME LANE DETAIL ON STANDARD SHEET TA 619-17 WHILE PERFORMING THE FULL AND PARTIAL DEPTH REPAIRS. REFER TO DRAWING TC-2 TO TC-3 FOR WORK ZONE TRAFFIC CONTROL TYPICAL SECTIONS AND ADDITIONAL WORK ZONE TRAFFIC CONTROL NOTES.
  - FOR FULL AND PARTIAL DEPTH REPAIR LOCATIONS AND DETAILS REFER TO DWG. NO. MST-01, TA STANDARD SHEET 402-01 AND MSD-01.
  - REFER TO DRAWING MSD-04 FOR GUIDE RAIL DETAIL AT WORK LOCATION 19.

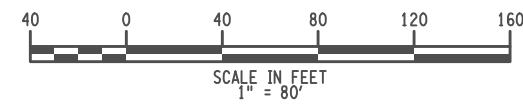

ITEM NUMBER	DESCRIPTION
606.26500108	SPECIAL TRANSITION
606.2701	HPBO (MOD.) CORRUGATED BEAM GUIDERAILING
606.75	REMOVING AND DISPOSING CONCRETE BARRIER
606.8903	TRANSITION: HEAVY POSTS BLOCKED OUT (MOD.) CORRUGATED BEAMGUIDE RAILING TO SINGLE SLOPE CONCRETE HALF SECTION BARRIER
606.9003	TRANSITION BETWEEN HALF-SECTION AND FULL-SECTION SINGLE SLOPE CONCRETE BARRIER (LEFT POCKET)
608.020102	ASPHALT CONCRETE SIDEWALKS, DRIVEWAYS AND BICYCLE PATHS AND VEGETATION CONTROL STRIPS

IT IS A VIOLATION OF LAW FOR ANY PERSON, UNLESS THEY ARE ACTING UNDER THE DIRECTION OF A LICENSED PROFESSIONAL ENGINEER, ARCHITECT, LANDSCAPE ARCHITECT, OR LAND SURVEYOR, TO ALTER AN ITEM IN ANY WAY. IF AN ITEM BEARING THE STAMP OF A LICENSED PROFESSIONAL IS ALTERED, THE ALTERING ENGINEER, ARCHITECT, LANDSCAPE ARCHITECT, OR LAND SURVEYOR SHALL STAMP THE DOCUMENT AND INCLUDE THE NOTATION "ALTERED BY" FOLLOWED BY THEIR SIGNATURE, THE DATE OF SUCH ALTERATION, AND A SPECIFIC DESCRIPTION OF THE ALTERATION.



REVISIONS			
DATE	DESCRIPTION	BY	SYL.

**Thruway Authority**

TITLE OF PROJECT: PAVEMENT REHABILITATION AND SAFETY IMPROVEMENTS  
 CONTRACT NUMBER: TANY 24-10  
 LOCATION OF PROJECT: NEW YORK DIVISION MP 24.0 TO 29.4  
 DATE: 2/2/2024  
 TITLE OF DRAWING: GENERAL PLANS  
 DRAWING NUMBER: GNP-25



Plotted By: USRW09220 D214812-H1391-1.cph\_gmp\_26.dgn  
 Design File: 06-MAR-2024 16119  
 Plotter: F.COSTANZO  
 CHECKED BY: F.COSTANZO  
 DRAFTED BY: R.MOHABIR  
 CHECKED BY: F.COSTANZO  
 DESIGNED BY: K.CZORA  
 DESIGN SUPERVISOR: B.LAGRAVE

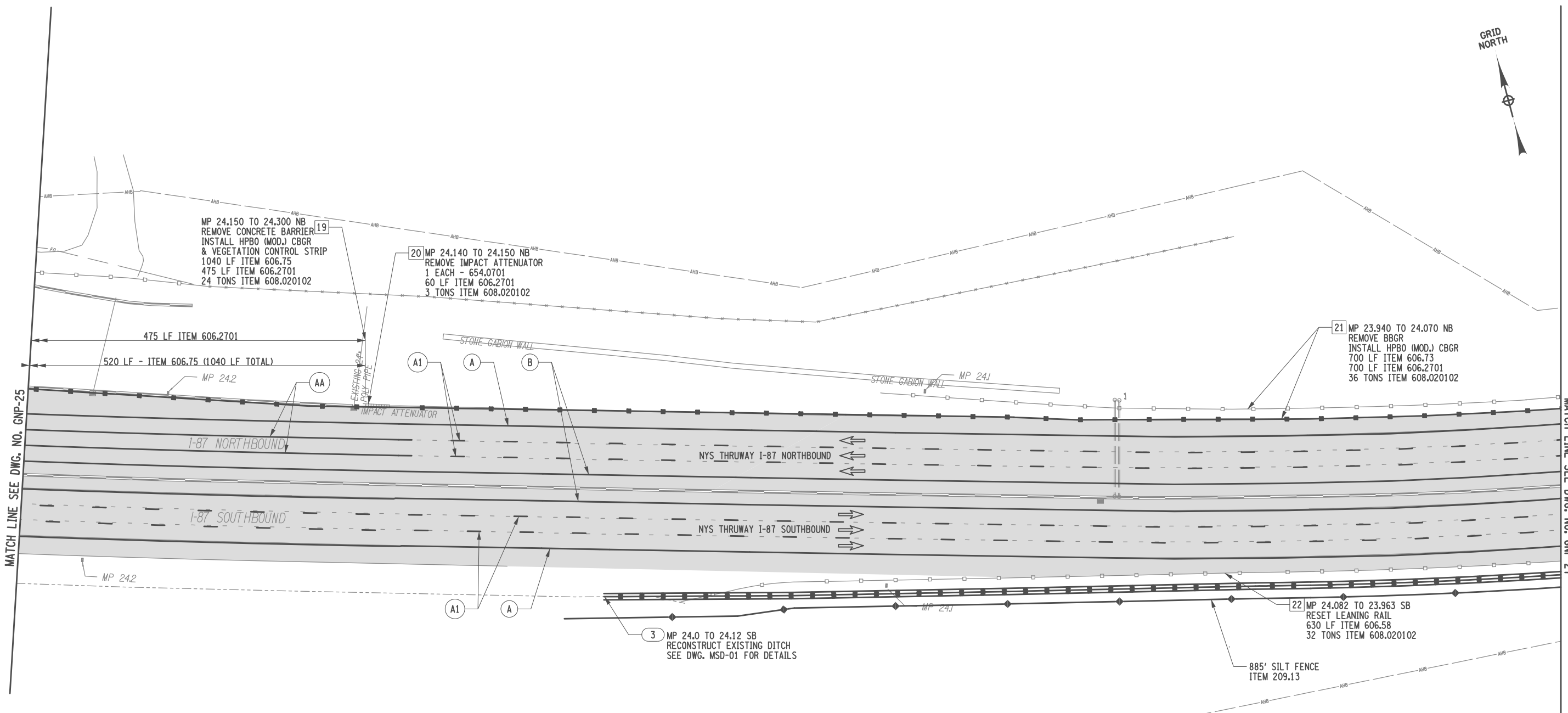

**STRIPING LEGEND**

SYMBOL	LINE TYPE	ITEM NUMBER	DESCRIPTION
A	6" WHITE EDGE LINE		WHITE HIGHLY REFLECTORIZED TRIPLE
AA	6" WHITE LANE LINE	685.1707 25	DROP EPOXY PAVEMENT STRIPES 6 INCH WIDTH X 20 MILS
A1	6" WHITE BROKEN LANE LINE		
B	6" YELLOW EDGE LINE	685.1708 25	YELLOW HIGHLY REFLECTORIZED TRIPLE DROP EPOXY PAVEMENT STRIPES 6 INCH WIDTH X 20 MILS
NOT APPLICABLE		635.04030225	RECESS DIAMOND GRINDING FOR INLAID PAVEMENT MARKINGS

**LEGEND:**

- XX - GUIDE RAIL WORK LOCATION
- XX - STRIPING TYPE    XX - DITCH RESTORATION WORK LOCATION
- 2" MILL AND INLAY LOCATIONS
- PARTIAL DEPTH REPAIR
- FULL DEPTH REPAIR

**NOTES:**

- UTILIZE THE NYSTA STANDARD SHEETS TA 619-08 AND TA 619-09 TO PROGRESS THE MAINLINE WORK. UTILIZE THE SUCCESSIVE WORKSPACES OCCUPYING THE SAME LANE DETAIL ON STANDARD SHEET TA 619-17 WHILE PERFORMING THE FULL AND PARTIAL DEPTH REPAIRS. REFER TO DRAWING TC-2 TO TC-3 FOR WORK ZONE TRAFFIC CONTROL TYPICAL SECTIONS AND ADDITIONAL WORK ZONE TRAFFIC CONTROL NOTES.
- FOR FULL AND PARTIAL DEPTH REPAIR LOCATIONS AND DETAILS REFER TO DWG. NO. MST-01, TA STANDARD SHEET 402-01 AND MSD-01.

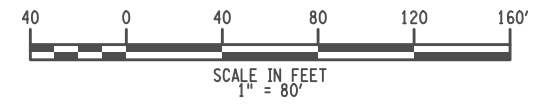

ITEM NUMBER	DESCRIPTION
209.13	SILT FENCE - TEMPORARY
606.2701	HPBO (MOD.) CORRUGATED BEAM GUIDERAILING
606.58	RESETTING HEAVY POST BLOCKED-OUT (MOD.) CORRUGATED BEAMGUIDE RAILING
606.73	REMOVING AND DISPOSING BOX BEAM GUIDE RAILING
606.75	REMOVING AND DISPOSING CONCRETE BARRIER
608.020102	ASPHALT CONCRETE SIDEWALKS, DRIVEWAYS AND BICYCLE PATHS AND VEGETATION CONTROL STRIPS
654.0701	REMOVE AND DISPOSE IMPACT ATTENUATOR SYSTEMS



IT IS A VIOLATION OF LAW FOR ANY PERSON, UNLESS THEY ARE ACTING UNDER THE DIRECTION OF A LICENSED PROFESSIONAL ENGINEER, ARCHITECT, LANDSCAPE ARCHITECT, OR LAND SURVEYOR, TO ALTER AN ITEM IN ANY WAY. IF AN ITEM BEARING THE STAMP OF A LICENSED PROFESSIONAL IS ALTERED, THE ALTERING ENGINEER, ARCHITECT, LANDSCAPE ARCHITECT, OR LAND SURVEYOR SHALL STAMP THE DOCUMENT AND INCLUDE THE NOTATION "ALTERED BY" FOLLOWED BY THEIR SIGNATURE, THE DATE OF SUCH ALTERATION, AND A SPECIFIC DESCRIPTION OF THE ALTERATION.

REVISIONS			
DATE	DESCRIPTION	BY	SYMBOL

**Thruway Authority**

TITLE OF PROJECT:  
PAVEMENT REHABILITATION AND SAFETY IMPROVEMENTS

LOCATION OF PROJECT:  
NEW YORK DIVISION  
MP 24.0 TO 29.4

TITLE OF DRAWING:  
**GENERAL PLANS**

CONTRACT NUMBER:  
TANY 24-10

DATE:  
2/2/2024

DRAWING NUMBER:  
GNP-26